

A clever combination

By mixing classic styles with contemporary colours and finishes, including a bold focal cooker hood, Louisa O'gilvie's new kitchen is the ideal design to update her period property

Words: Lindsay Blair Photography: Lind & Cumming Design Photography

By extending the house to the side, Louisa and Grant ended up with a rectangular room which could be separated into cooking and eating areas – perfect for all the family. Pia first designed the kitchen to have integrated bench seating, but she and the couple felt this wouldn't create the zones they wanted. Instead, the kitchen space flows into a dining area, complete with a chunky wooden table with a bench, dining chairs and enough space to comfortably seat six.

FACTFILE

Who lives here?

Louisa O'gilvie, a stay-at-home mum, and her self-employed husband Grant with their three children Finlay, five, James, four, and Alexandra, two.

What type of house is it?

A six-bedroom Arts and Crafts house built in the 1890s in Clapham Old Town, south west London.

What was the aim of the project?

To create a light-filled, single-level kitchen-

diner with good links to the garden. Louisa and Grant also wanted a clever mix of contemporary and classic style.

Who designed the kitchen?

Pia Rosling, design director at Sola Kitchens.

How much did it cost?

Around £40,000 for the kitchen, including all appliances.

How long did it take?

Five months for the kitchen design and installation.

"Brass, copper, and wrought iron finishes are right on trend and will add plenty of visual interest to a space. Just be aware, when adding any metallic finish to your kitchen, that it will change colour and texture as it ages with time. Most designs now come with a nano-technology coating to maintain the look, and I'd suggest waxing the surface as soon as the appearance begins to change."

**Pia Rosling, design director,
Sola Kitchens**



Longevity was the main concern when choosing the kitchen's style and finishing touches. Louisa knew what she wanted: brass fittings, a statement cooker hood, and a combination of natural wood and painted cabinetry. "I don't like anything looking too new and shiny, and I like to mix old and new styles," she explains. "I was conscious of choosing designs that wouldn't date too quickly." Keen to create a focal point, Louisa spotted a gold cooker hood on Pinterest. A long search of UK suppliers brought her no luck, but US-based Texas Lightsmith created a similar piece to Louisa's exact requirements. "It's my favourite part of the kitchen and I know I won't see another one like it," she says. The open shelving either side adds attractive storage for crockery and cookbooks and allows the hood to be the design focus. "Structurally, this kitchen had numerous challenges – including where to site the ducting for the hood, since the ceiling is sloped and provided little room for the required system," designer Pia Rosling explains. "To get around this, the extractor was designed to re-circulate the air, so no pipework was needed."

The cabinetry was designed in a wide galley layout around the glazed section of floor, which allows daylight to filter down into a new basement living room. A similar parquet flooring, in a lighter shade, is used downstairs. This creates a visual link between the two areas and also works well with both the kitchen's painted and natural wooden units. The ash base cupboards are painted in Farrow & Ball's Shaded White, and the tall units are made from walnut which has been left untreated. "The walnut has been stained to give it an aged appearance, which warms up the look and complements the flooring," says Pia. Brass features throughout the design, including in the taps and handles, while the stainless steel American-style fridge-freezer adds a modern edge.

Although it is the only full-height unit in the space, it was important the walnut cabinet wouldn't dominate. As such, the practical and aesthetically pleasing addition of glass panels in the larder and crockery stores not only mean you can easily see the contents, but it also breaks up the expanse of wood. The interiors have been designed with Louisa's storage requirements in mind, ensuring there's enough shelf height for tall glasses and bottles as well as jars and stacks of plates.



"I love the way the unit is built around the fridge-freezer to make best use of the space."

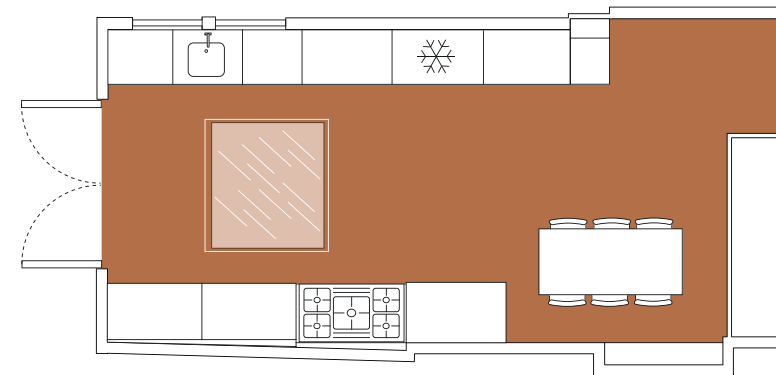

"I really wanted a big, old wooden cupboard, but I struggled to find one I liked in the right size," says Louisa. "Pia suggested a fabulous solution. The made-to-measure design in walnut is exactly as I imagined. I love the way it is built around the fridge-freezer to make good use of all the space."



SourceBook

DESIGN

Design Sola Kitchens (020 3004 0898 or solakitchens.com)

KITCHEN

Cabinetry Sola Kitchens, as before, painted in Shaded White, Farrow & Ball (01202 876141 or farrow-ball.com)
 Handles Armac Martin (0121 359 2111 or martin.co.uk)
 Worktop Crema Botticino 20mm Polished, Sola Kitchens, as before
 Shelving For similar try Ikea (020 3645 0000 or ikea.com/gb)
 Appliances Range cooker, Rangemaster (0800 804 6261 or rangemaster.co.uk); Dishwasher and American-style fridge-freezer, Bosch (0330 123 9339 or bosch-home.co.uk); Cooker hood, Texas Lightsmith (+1 5122642266 or texaslightsmith.com)
 Tiles Topps Tiles (0800 783 6262 or toppstiles.co.uk)
 Wall paint Slipper Satin, Farrow & Ball, as before
 Flooring The Natural Wood Flooring Company (020 8871 9771 or naturalwoodfloor.co.uk)
 Lighting Buster + Punch (020 7407 0888 or busterandpunch.com); Bert Frank (020 7164 6482 or bertfrank.co.uk)
 Tap Ebay. For similar try Perrin & Rowe (01708 526361 or perrinandrowe.co.uk)
 Sink Sinks-taps.com (01759 307262 or sinks-taps.com)
 Dining table and bench Atkin and Thyme (020 3768 7775 or atkinandthyme.co.uk)
 Chairs Ebay. For similar try Amara (0800 587 7645 or amara.com)
 Rooflight For similar try Velux (01592 778225 or velux.co.uk)
 Patio doors For similar try Mumford & Wood (01621 818155 or mumfordwood.com)

COST

Around £40,000 for the kitchen, including appliances but excluding construction